

# Product Data Sheet

**Product Name:**

CLC-1 WM 6" Light Cove / Sconce  
Interior / Exterior Applications

**Manufacturer:**

Columbia Architectural Products, Inc.  
10722 Tucker Street  
Beltsville, Maryland 20705  
phone: (301) 937-4383  
fax: (301) 937-6850  
web: [www.capacm.com](http://www.capacm.com)

**Light Cove Description:**

The CAP CLC-1 WM Light Cove is a 6" Radius Aluminum Composite Wall Mount System designed to receive a typical fluorescent double light fixture or LED lighting.

These Light Coves are used for both residential and commercial applications such as Apartments and Condominiums, Office Buildings, Casinos, Schools, Airports, Retail Establishments, etc.

**Solid Color Selection:**



**Mica Color Selection:**

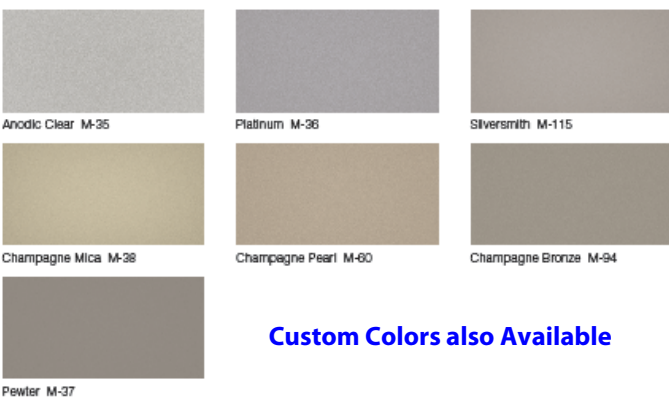

**Custom Colors also Available**

Samples are available upon request. CAP Industries and Alucoil® take a different approach to address a growing market trend. Contact one of our helpful staff members at CAP Industries for assistance.

©2012

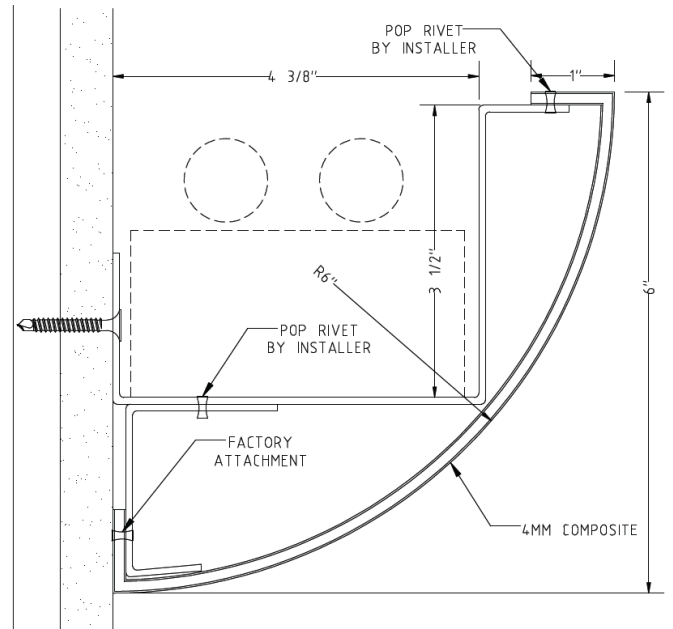

**CLC-1 WM  
Wall Mount**

**Stock Lengths:**

-Pre-finished coil coated Kynar in lengths up to 60"

**Aluminum Composition:**

-4mm Composite, PE Core.

**Available Options:**

- Custom cut to length sizes
- Factory cut inside and outside miters
- End Caps
- Tangent Fin / Soffit Mount (TF)
- Wall Mount (WM)
- Fire rated Core

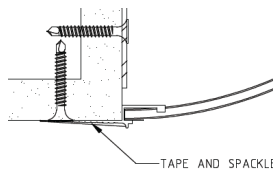

**CLC-1 TF  
Tangent Fin**

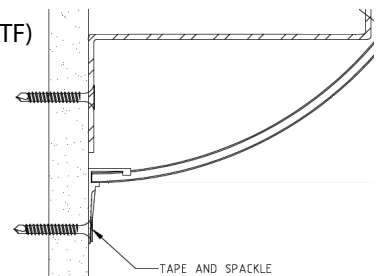

**CLC-1 PF  
Perpendicular Fin**

**Metallic Color XL Selection:**



Columbia Architectural Products, Inc.  
Manufacturers of Architectural Metal Products  
Colors shown are provided by Alucoil® N. America